

PI SERIES

For Inverter, High IR, Large Capacitor

Features

- Screw terminal type
- Smaller dimensions and large capacity
- Large allowable ripple current
- High reliability for continuous operation
- Load life of 5000 hours at 85°C

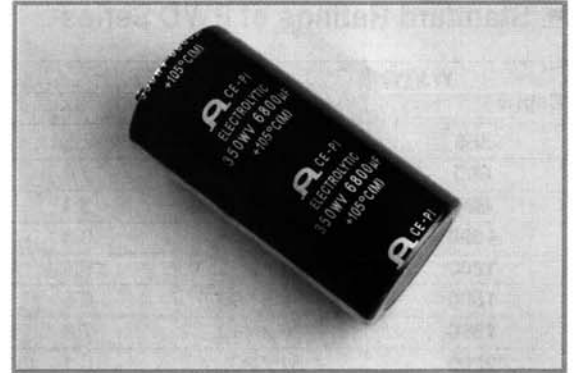

Specifications

Item	Performance Characteristics	
Operating temperature range	-25°C ~ +85°C	
Rated working voltage range	315V ~ 400V	
Nominal capacitance range	2700μF ~ 12000μF, ±20% (at 20°C, 120Hz)	
D.C Leakage current(at 20°C)	The following specifications shall be satisfied when the rated voltage is applied for the required time. $I \leq 0.02CV$ or 5mA(5 min), whichever is less Where I =Leakage current(μA) C=Nominal capacitance(μF) V=Rated voltage(V)	
Tanδ (max., at 20°C, 120Hz)	W.V(V)	315 ~ 400V
	Tan δ	0.20
Characteristics at low temperature(max.) (impedance ratio at 120Hz)	W.V(V)	315 ~ 400V
	Z-25°C/+20°C	8
Load life	After applying rated working voltage for 5000 hours at +85°C and then being stabilized at +20°C, capacitors shall meet following limits.	
	Capacitance change	Within ±20% of the initial measured value
	Tan δ	≤ 300% of the initial specified value
	Leakage current	≤ The initial specified value
Shelf life	After storage for 1000 hours at +85°C with no voltage applied and then being stabilized at +20°C, capacitors shall meet following limits.	
	Capacitance change	Within ± 25% of the initial measured value
	Tan δ	≤ 300% of the initial specified value
	Leakage current	≤ 200% of the initial specified value

Dimensions

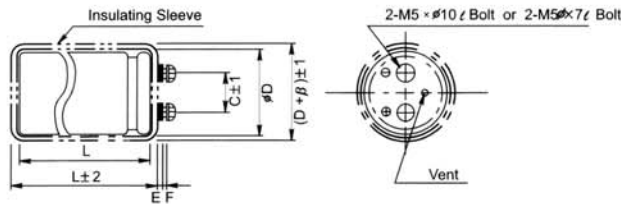

Standard lead style

φD	C	E	F	β
35	12.7	2.5	6.0	1.0
51	22.0	2.5	6.0	1.5
63.5	28.6	2.5	6.0	1.5
76	31.0	1.5	6.5	1.5
89	31.0	1.5	6.5	1.5

Ripple current coefficient

Frequency

Freq(Hz)	60	120	300	1K	3K
Factor	0.8	1.0	1.1	1.3	1.40

Temperature

Temperature	40°C	60°C	85°C
Factor	1.89	1.67	1.0



PI SERIES

Standard Ratings of PI Series

φ DXL(mm)

Cap(μF)	W.V(V)	315(2F)		350(2V)		400(2G)	
		SIZE	I _r	SIZE	I _r	SIZE	I _r
2700		63.5 x 90	8.3	63.5X100	9.7	63.5X110	10.5
3300		63.5 x 100	10.2	63.5X110	11.7	63.5X120	11.2
3900		63.5 x 110	11.1	63.5X120	12.5	63.5X130	12.8
4700		63.5 x 120	12.8	63.5X130	14.3	76X120	14.7
5600		63.5 x 150	14.2	76X120	16.1	76X130	16.9
6800		76 x 120	17.3	76X130	18.6	76X160	20.2
8200		76 x 150	21.1	76X160	22.2	76X170	22.8
10000		76 x 160	24.0	76X170	25.2	89X160	26.6
12000		89 x 150	27.9	89X160	29.1		

I_r: Maximum Permissible Ripple Current[A(rms) at 85°C, 120Hz]

Case size [φ DxL(mm)]