

# PWC SERIES

For welder, high IR, Large Capacitor

## Features

- Screw terminal type
- Smaller dimensions and large capacity
- Large allowable ripple current
- High reliability for continuous operation
- Load life of 2000 hours at 85°C



## Specifications

Item	Performance Characteristics	
<b>Operating temperature range</b>	-25°C ~ +85°C	
<b>Rated working voltage range</b>	315V ~ 400V	
<b>Nominal capacitance range</b>	560μF ~ 6800μF, ±20% (at 20°C, 120Hz)	
<b>D.C Leakage current(at 20°C)</b>	The following specifications shall be satisfied when the rated voltage is applied for the required time. $I \leq 0.02CV$ or 2mA(5 min), whichever is less Where I =Leakage current(μA)    C=Nominal capacitance(μF)    V=Rated voltage(V)	
<b>Tan δ (max., at 20°C, 120Hz)</b>	W.V(V)	315 ~ 400V
	Tan δ	0.10
<b>Characteristics at low temperature(max.) (impedance ratio at 120Hz)</b>	W.V(V)	315 ~ 400V
	Z-25°C/+20°C	6
<b>Load life</b>	After applying rated working voltage for 2000 hours at +85°C and then being stabilized at +20°C, capacitors shall meet following limits.	
	Capacitance change	Within ±20% of the initial measured value
	Tan δ	≤ 150% of the initial specified value
	Leakage current	≤ The initial specified value
<b>Shelf life</b>	After storage for 1000 hours at +85°C with no voltage applied and then being stabilized at +20°C, capacitors shall meet following limits.	
	Capacitance change	Within ± 25% of the initial measured value
	Tan δ	≤ 150% of the initial specified value
	Leakage current	≤ 200% of the initial specified value

## Dimensions

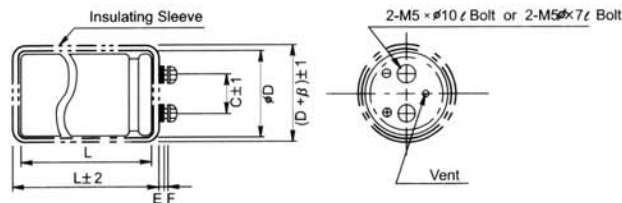

### Standard lead style

φ D	C	E	F	β
35	12.7	2.5	6.0	1.0
51	22.0	2.5	6.0	1.5
63.5	28.6	2.5	6.0	1.5
76	31.0	1.5	6.5	1.5
89	31.0	1.5	6.5	1.5

## Ripple current coefficient

### Frequency

Freq(Hz)	50	120	400	1K	10K
Factor	0.8	1.0	1.20	1.30	1.40

### Temperature

Temperature	≤ 20°C	40°C	70°C	85°C
Factor	3.30	2.65	1.65	1.0

# PWC SERIES

## Standard Ratings of PWC Series

 $\phi$  DXL(mm)

Cap( $\mu$ F)	W.V(V)	315(2F)		350(2V)		400(2G)	
		SIZE	I <sub>r</sub>	SIZE	I <sub>r</sub>	SIZE	I <sub>r</sub>
560		35 x 60	2.5	35 x 70	2.8	35 x 70	3.0
680		35 x 70	3.0	35 x 80	4.0	35 x 80	4.7
820		35 x 80	3.4	35 x 90	4.5	35 x 90	5.2
1000		35 x 90	3.8	35 x 100	5.0	51 x 70	5.8
1200		35 x 100	5.4	35 x 120	6.2	51 x 80	7.0
1500		35 x 100	6.5	51 x 80	7.4	51 x 90	8.3
1800		35 x 110	7.0	51 x 90	8.5	51 x 90	9.1
2200		51 x 80	8.1	51 x 110	9.0	51 x 100	9.8
2700		51 x 100	9.2	51 x 120	10.2	63.5 x 110	10.4
3300		51 x 120	9.7	63.5 x 100	10.8	63.5 x 130	11.4
3900		63.5 x 100	11.9	63.5 x 120	12.5	63.5 x 140	13.1
4700		63.5 x 110	13.4	76 x 100	14.1	76 x 130	14.5
5600		63.5 x 120	14.5	76 x 120	16.3	76 x 140	16.7
6800		76 x 100	16.6	76 x 130	18.9	76 x 170	20.1

 I<sub>r</sub> : Maximum Permissible Ripple Current[A(rms) at 85°C, 120Hz]

 Case size [  $\phi$  DxL(mm) ]