

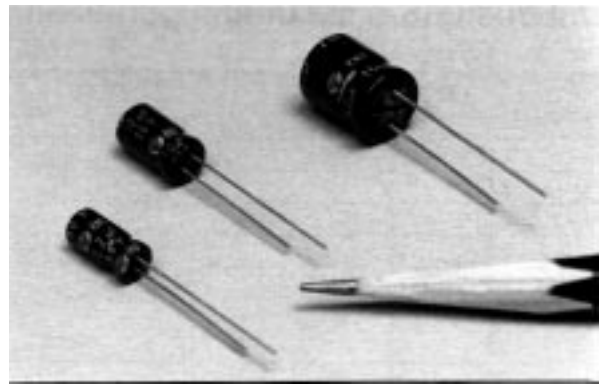

■ Features

- Bi-polar (Radial)
- Ideal for inconsistent polarity circuits
- For the compaction of equipment
- load life of 1000 hours at 85°C



■ Specifications

Item	Performance Characteristics				
Operating temperature range	-40°C ~ +85°C				
Rated working voltage range	10V ~ 50V				
Nominal capacitance range	0.47μF ~ 1000μF, ±20%(at 20°C, 120Hz)				
D.C Leakage current(at 20°C)	The following specifications shall be satisfied when the rated voltage is applied for the required time. $I \leq 0.03CV + 3\mu A(3 \text{ min})$ Where I=Leakage current(μA) C=Nominal capacitance(μF) V=Rated voltage(V)				
Tan δ (max., at 20°C, 120Hz)	W.V(V)	10	16	25	50
	Tan δ	0.25	0.20	0.17	0.15
Characteristics at low temperature(max.) (impedance ratio at 120Hz)	W.V(V)	10	16	25	50
	Z-25°C/Z20°C	3	2	2	2
	Z-40°C/Z20°C	8	6	4	3
Load life	After applying rated working voltage for 1000 hours at +85°C with the polarity inverted every 250 hours and then being stabilized at +20°C, capacitors shall meet following limits.				
	Capacitance change	Within ± 20% of initial measured value			
	Tan δ	≤ 150% of initial specified value			
	Leakage current	≤ Initial specified value			
Shelf life	After storage for 500 hours at +85°C with no voltage applied and then being stabilized at +20°C, capacitors shall meet following limits.				
	Capacitance change	Within ± 20% of initial measured value			
	Tan δ	≤ 150% of initial specified value			
	Leakage current	≤ 200% of initial specified value			

■ Case sizes and Dimensions

■ Dimensions & Maximum permissible ripple current [mA(rms) at 85°C, 120Hz]

∅D x L(mm)

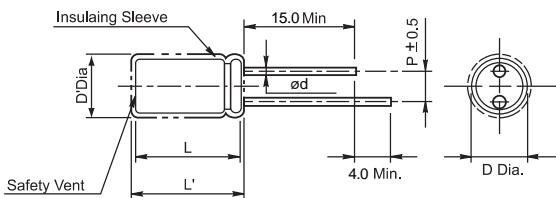

• Standard lead style

∅D	5.0	6.3	8.0	10.0	13.0	16.0
p	2.0	2.5	3.5	5.0		7.5
∅d	0.5		0.6			0.8

D' = [D+0.5]Max.

L' = [L+1.0]Max. at D ≤ 8.0

L' = [L+1.5]Max. at D ≥ 10.0

W.V Cap(μF)	10(1A)		16(1C)		25(1E)		50(1H)	
	SIZE	I _r	SIZE	I _r	SIZE	I _r	SIZE	I _r
0.47							5 x 11	10
1.0							5 x 11	16
2.2							5 x 11	26
3.3							5 x 11	33
4.7					5 x 11	27	6.3 x 11	42
10					5 x 11	50	8 x 11.5	70
22	5 x 11	62	6.3 x 11	75	6.3 x 11	90	10 x 12.5	120
33	6.3 x 11	82	6.3 x 11	100	8 x 11.5	115	10 x 16	160
47	6.3 x 11	105	8 x 11.5	125	10 x 12.5	150	10 x 20	200
100	8 x 11.5	165	10 x 12.5	200	10 x 16	260	13 x 20	340
220	10 x 16	270	10 x 20	340	13 x 20	420		
330	10 x 20	340	13 x 20	430				
470	13 x 20	440	13 x 25	550				
1000	16 x 25	700	16 x 25	900				