

RSA SERIES



ALUMINUM ELECTROLYTIC CAPACITORS

Miniature, 7mm Height, High CV, Radial Leads

■ Features

- Miniature, High CV, Radial
- Lengths are all 7mm (Smaller than RSM)
- VTR, video camera, car radio, micro cassette tape recorder etc.
- Low cost alternative to tantalum beads
- Load life of 1000 hours at 85°C

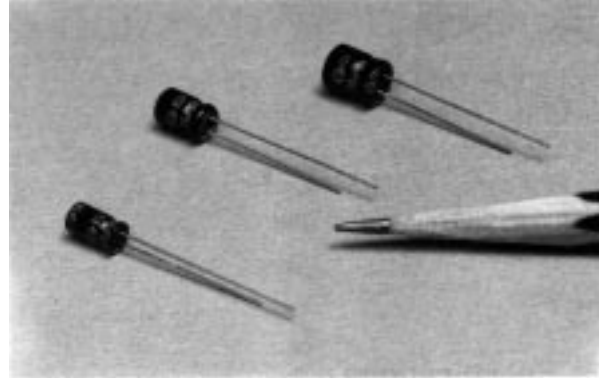

■ Specifications

Item	Performance Characteristics							
Operating temperature range	-40°C ~ +85°C							
Rated working voltage range	6.3V ~ 50V							
Nominal capacitance range	0.1μF ~ 220μF, ±20% (at 20°C, 120Hz)							
D.C Leakage current (at 20°C)	The following specifications shall be satisfied when the rated voltage is applied for the required time. $I \leq 0.01CV$ or $3\mu A$ (2 min), whichever is greater Where I = Leakage current (μA) C = Nominal capacitance (μF) V = Rated voltage (V)							
Tan δ (max., at 20°C, 120Hz)	W.V (V)	6.3	10	16	25	35	50	
	Tan δ	0.26	0.22	0.19	0.16	0.12	0.10	
Characteristics at low temperature (max.) (impedance ratio at 120Hz)	W.V (V)	6.3	10	16	25	35	50	
	Z-25°C/Z20°C	4	3	2	2	2	2	
Load life	Z-40°C/Z20°C	8	6	4	4	4	4	
	After applying rated working voltage for 1000 hours at +85°C and then being stabilized at +20°C, capacitors shall meet following limits.							
Shelf life	Capacitance change	Within ± 25% of initial measured value						
	Tan δ	≤ ± 200% of initial specified value						
	Leakage current	≤ Initial specified value						
Shelf life	After storage for 1000 hours at + 85°C with no voltage applied and then being stabilized at +20°C, capacitors shall meet following limits.							
	Capacitance change	Within ± 20% of initial measured value						
	Tan δ	≤ 200% of initial specified value						
	Leakage current	≤ 200% of initial specified value						

■ Case sizes and Dimensions

■ Dimensions & Maximum permissible ripple current [mA(rms) at 85°C, 120Hz]

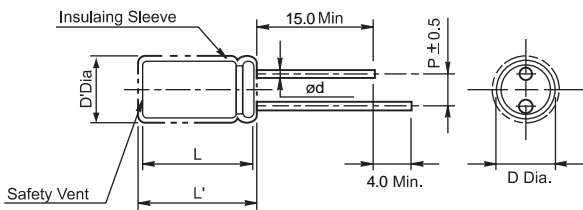

• Standard lead style

øD	4.0	5.0	6.3
P	1.5	2.0	2.5
ød	0.45		

D' = [D+0.5] Max.

L' = [L+1.0] Max.

W.V	øDxL (mm)											
	6.3		10		16		25		35		50	
Cap (μF)	SIZE	I _r	SIZE	I _r	SIZE	I _r	SIZE	I _r	SIZE	I _r	SIZE	I _r
0.1											4x7	1
0.22											4x7	2
0.33											4x7	3
0.47											4x7	5
1.0											4x7	10
2.2											4x7	16
3.3											4x7	18
4.7									4x7	21	4x7	25
6.8									4x7	25	5x7	28
10							4x7	28	4x7	31	5x7	35
22			4x7	35	4x7	40	5x7	50	5x7	55	6.3x7	58
33	4x7	40	4x7	44	5x7	55	5x7	63	6.3x7	66		
47	4x7	48	5x7	60	5x7	65	6.3x7	78				
100	5x7	78	6.3x7	87	6.3x7	98						
220	6.3x7	110										