

## ■ Features

- Bi-polar, Radial
- Ideal for inconsistent polarity circuits
- High performance
- load life of 1000 hours at 105°C

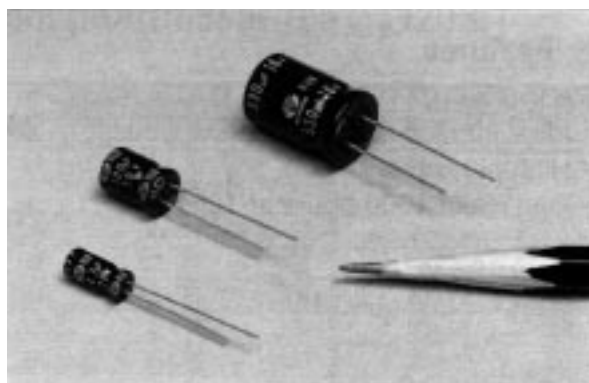

## ■ Specifications

Item	Performance Characteristics				
Operating temperature range	-40°C ~ +105°C				
Rated working voltage range	10V ~ 50V				
Nominal capacitance range	0.47μF ~ 1000μF, ±20%(at 20°C, 120Hz)				
D.C Leakage current(at 20°C)	The following specifications shall be satisfied when the rated voltage is applied for the required time. $I \leq 0.03CV$ or $3\mu A(5 \text{ min})$ , whichever is greater Where I=Leakage current(μA) C=Nominal capacitance(μF) V=Rated voltage(V)				
Tan δ(max., at 20°C, 120Hz)	W.V(V)	10	16	25	50
	Tan δ	0.20	0.17	0.16	0.12
Characteristics at low temperature(max.) (impedance ratio at 120Hz)	W.V(V)	10	16	25	50
	Z-25°C/Z20°C	3	2	2	2
Load life	Z-40°C/Z20°C	6	4	3	3
	After applying rated working voltage for 1000 hours at +105°C with the polarity inverted every 250 hours and then being stabilized at +20°C, capacitors shall meet following limits.				
Shelf life	Capacitance change	Within ±20% of initial measured value			
	Tan δ	≤ 200% of initial specified value			
	Leakage current	≤ Initial specified value			
Shelf life	After storage for 500 hours at +105°C with no voltage applied and then being stabilized at +20°C, capacitors shall meet following limits.				
	Capacitance change	Within ±20% of initial measured value			
	Tan δ	≤ 150% of initial specified value			
	Leakage current	≤ 200% of initial specified value			

## ■ Case sizes and Dimensions

## ■ Dimensions & Maximum permissible ripple current [mA(rms) at 105°C, 120Hz]

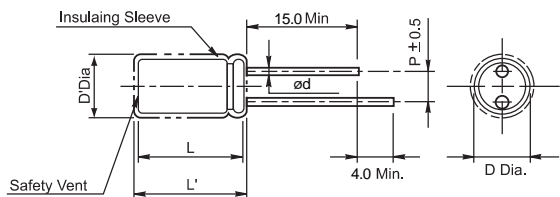

### • Standard lead style

øD	5.0	6.3	8.0	10.0	13.0	16.0
p	2.0	2.5	3.5	5.0		7.5
ød	0.5		0.6			0.8

D' = [D+0.5]Max.

L' = [L+1.0]Max. at D ≤ 8.0

L' = [L+1.5]Max. at D ≥ 10.0

W.V Cap(μF)	10		16		25		50	
	SIZE	I <sub>R</sub>	SIZE	I <sub>R</sub>	SIZE	I <sub>R</sub>	SIZE	I <sub>R</sub>
0.47							5x11	8
1.0							5x11	11
2.2							5x11	18
3.3							5x11	22
4.7					5x11	21	6.3x11	29
10					5x11	35	8x11.5	50
22	5x11	44	6.3x11	55	6.3x11	62	10x12.5	85
33	6.3x11	58	6.3x11	70	8x11.5	80	10x16	110
47	6.3x11	75	8x11.5	89	10x12.5	105	10x20	143
100	8x11.5	118	10x12.5	135	10x16	171	13x20	243
220	10x16	190	10x20	252	13x20	310		
330	10x20	245	13x20	320				
470	13x20	330	13x25	410				
1000	16x25	570	16x25	670				