

# FW1238 DC Series Fan

# Fan Well

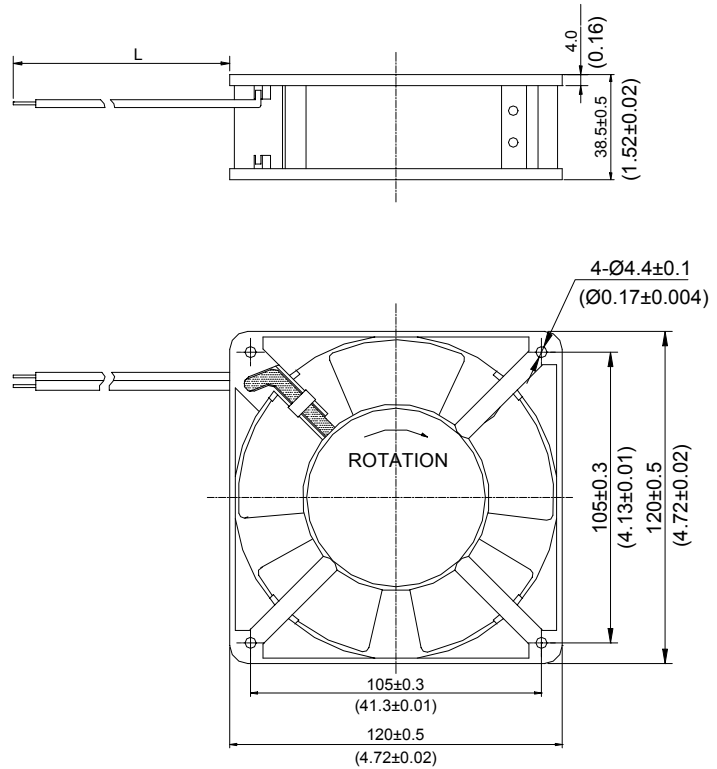

*DC Fan*  
**PERFORMANCE**  
 76-105 CFM

## 120mm sq. x 38mm (4.72 in sq. x 1.52 in)

### FEATURES

- Motor:** Brushless DC with permanent magnet.
- Air Flow:** 76.4-104.6 CFM
- Weight:** 266g (9.3oz)
- Noise (dBA):** 33.38-41.58 dBA
- Housing & Impeller:** Glass filled thermoplastic in black color rated UL94V-0.
- Dielectric Strength:** 500VAC for one minute or 600VAC for 2 seconds between housing and lead wire(+).
- Insulation Resistance:** >500M Ohm between internal stator and lead wire (+) measured by 500VDC.
- Leads:** Two wires, Type UL 1007, +Red/-Black.
- Protection:** Locked rotor protected.
- Bearing System:** Sleeve or ball bearing.
- Standards:** UL, CUL, CE, TUV

Dimensions are in millimeters. ( ) are in inches.  
 Non-stock items may be subject to lead time.

### FAN PERFORMANCE CURVES

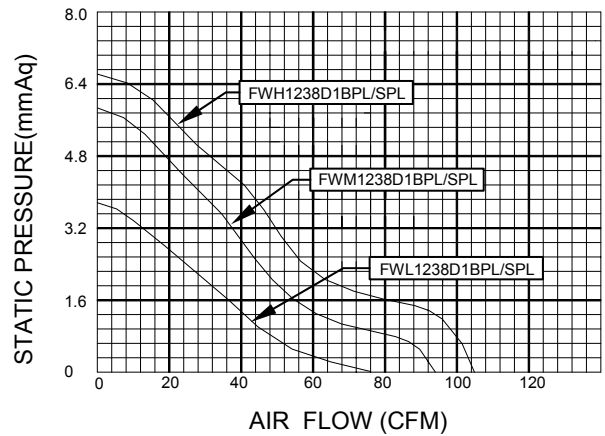

MODEL	PART NUMBER	BEARING SYSTEM	VOLTAGE (V/Hz)	CURRENT (A)	SPEED (RPM)	AIR FLOW (CFM)	PRESSURE (mmAq)	NOISE (dBA)	LIFE EXP (Hours)	WEIGHT (g)
FW1238HD1	FWH1238D1BPL FWH1238D1SP	Ball Sleeve	24	0.32	2800	104.8	6.74	42.8	50,000 30,000	297
FW1238MD1	FWM1238D1BPL FWM1238D1SP	Ball Sleeve	24	0.23	2540	94.0	6.11	41.0	50,000 30,000	297
FW1238LD1	FWL1238D1BPL FWL1238D1SP	Ball Sleeve	24	0.14	1950	72.3	3.37	32.9	50,000 30,000	297