

# FW2510 DC Series Fan

Fan Well

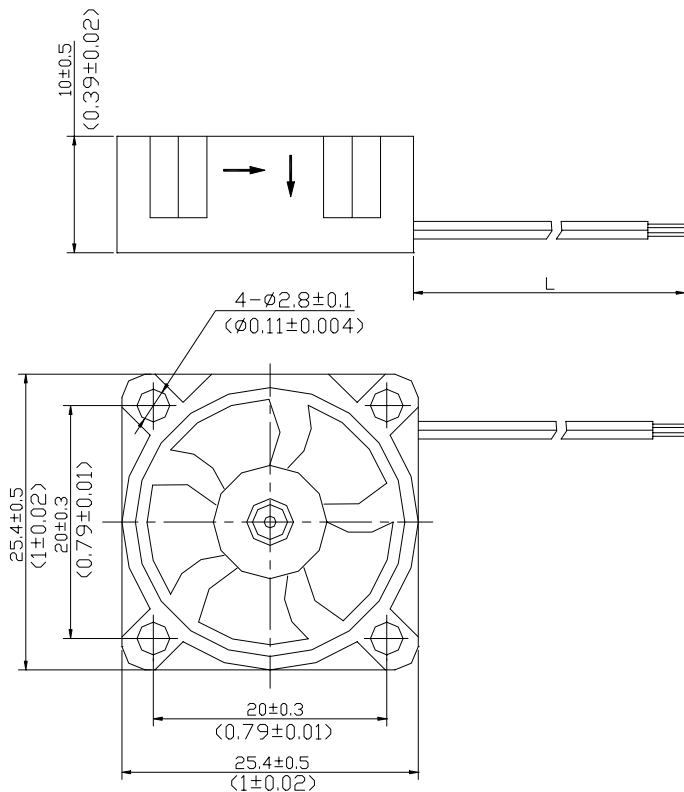

*DC Fan*  
**PERFORMANCE**  
 1.5-2.8 CFM



**25mm sq. x 10mm (1.0 in sq. x 0.39 in)**

### FEATURES

- Motor:** Brushless DC with permanent magnet.
- Air Flow:** 1.52-2.82 CFM
- Weight:** 7g (0.25oz)
- Noise (dBA):** 22.5-25.0 dBA
- Housing & Impeller:** Glass filled thermoplastic in black color rated UL94V-0.
- Dielectric Strength:** 500VAC for one minute or 600VAC for 2 seconds between housing and lead wire(+).
- Insulation Resistance:** >500M Ohm between internal stator and lead wire (+) measured by 500VDC.
- Leads:** Two wires, Type UL 1007, +Red/-Black.
- Protection:** Locked rotor protected.
- Bearing System:** Sleeve or ball bearing.
- Standards:** UL, CUL, CE, TUV

Dimensions are in millimeters. ( ) are in inches.  
 Non-stock items may be subject to lead time.

### FAN PERFORMANCE CURVES

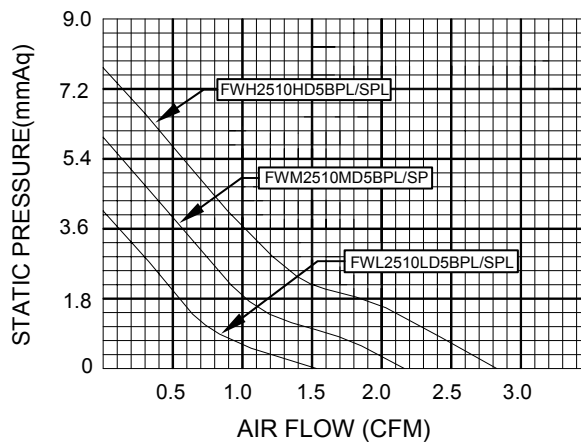

MODEL	PART NUMBER	BEARING SYSTEM	VOLTAGE (V/Hz)	STARTUP (V)	CURRENT (A)	SPEED (RPM)	AIR FLOW (CFM)	PRESSURE (mmAq)	NOISE (dBA)	LIFE EXP (Hours)	WEIGHT (g)
FW2510HD5	FWH2510D5BPL	Ball	5	2	0.20	13000	2.82	7.76	25.0	50,000	7
	FWH2510D5SPL	Sleeve			0.22						
FW2510MD5	FWM2510D5BPL	Ball	5	2	0.16	10000	2.17	5.97	23.5	50,000	7
	FWM2510D5SPL	Sleeve			0.20						
FW2510LD5	FWL2510D5BPL	Ball	5	2	0.10	7000	1.52	4.18	22.5	50,000	7
	FWL2510D5SPL	Sleeve			0.14						