

MATERIAL:

- Sleeve: Brass Gold or Tin over Nickel plated
- Clip: Beryllium Copper Gold over Nickel plated

FEATURES:

- Funnel shaped four-fingered and six-fingered contacts provide easy IC insertion and withdrawal, high reliability.
- Gold plated contact to ensure low contact resistance and Tin plated terminal to prevent contamination during soldering.
- All plastic are UL 94V-0 grade fire retardant.
- Fit standard pitch with 2.54 mm x 2.54 mm(0.1" x 0.1") pin spacing.

ELECTRICAL PERFORMANCE:

- Contact Rating 1 ADC Max.
- Contact Resistance 10 mΩ Max.
- Insulation Resistance 10⁶ MΩ Min. at 100 VDC
- Dielectric Strength 1000 VAC Min. for 1 minute
- Capacitance between adjacent pin 0.9 pF Max.

ENVIRONMENTAL PERFORMANCE:

- Temperature Rating:
Operating -55°C to +125°C
- Life cycle with insertion and withdrawal :
100 operating cycles Min.
- Humidity: 90~95%RH, 40°C for 96 Hrs.

MECHANICAL PERFORMANCE:

- Vibration: per MIL-STD-202F METHOD 204D
- Solderability: per MIL-STD-202F METHOD 208D
- Soldering Heat: 260±5°C for 5±1 seconds

CONSTRUCTION OF PIN:

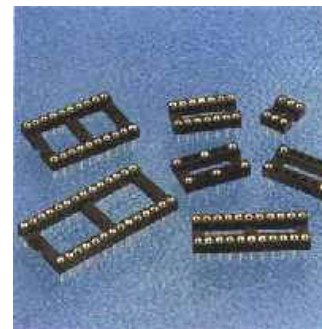
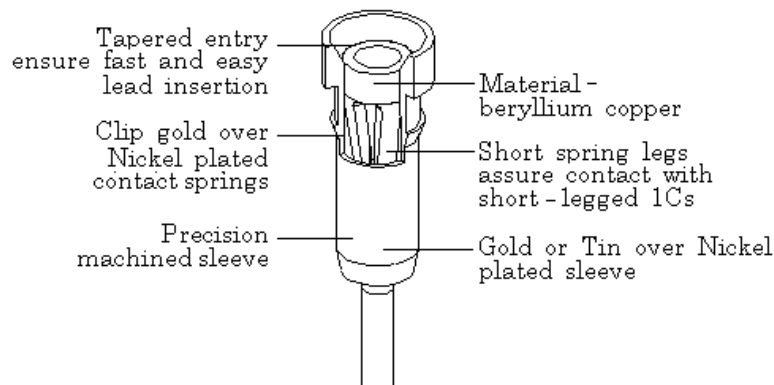

DIMENSIONS OF CIRCUITRY: Unit: mm (inch)

STANDARD PIN

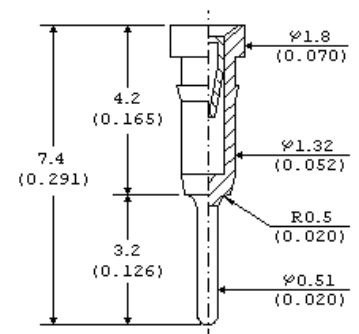
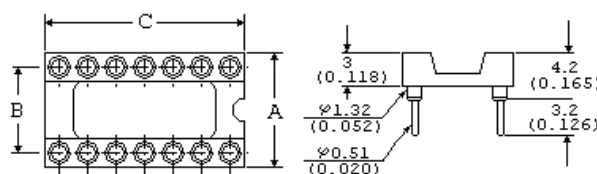
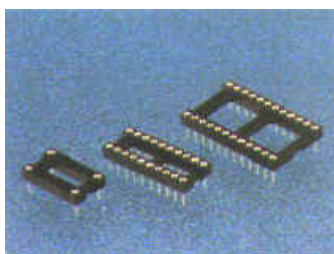

WIRE-WRAP PIN

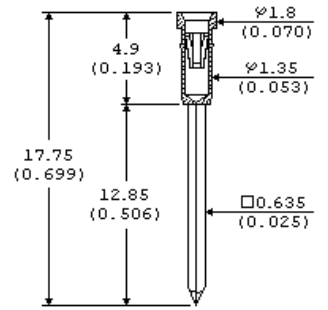
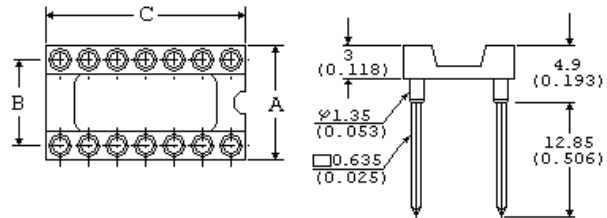
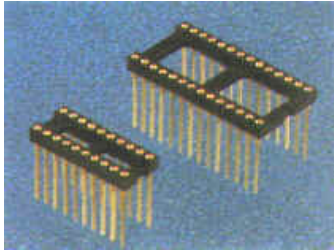

SOLDER FORK PIN

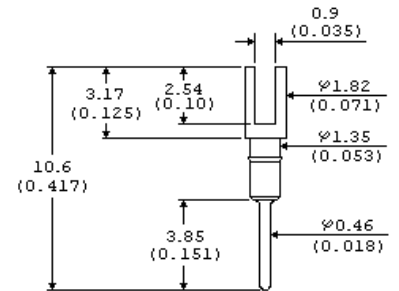
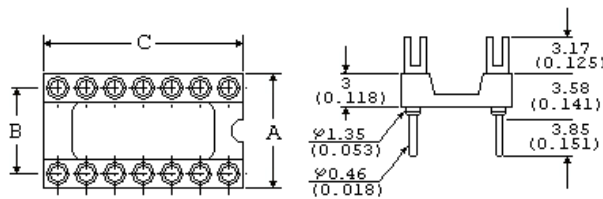
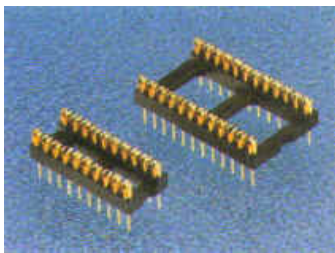

STRAIGHT PIN

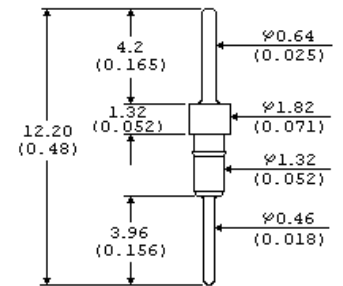
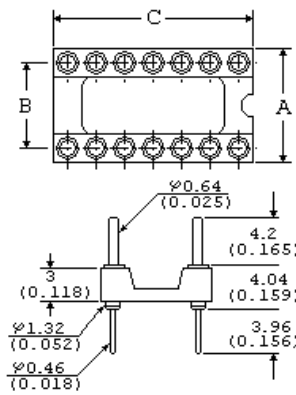
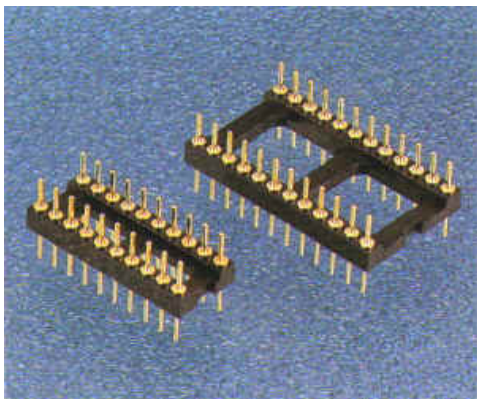

CARRIER

