

Recommended P.C. Board SMD Layout

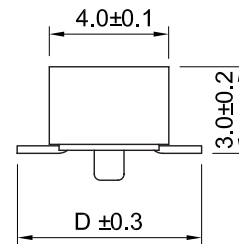
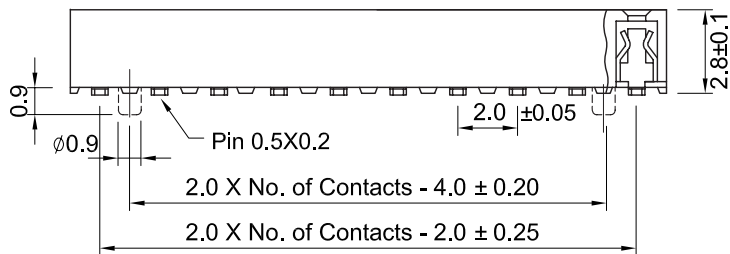
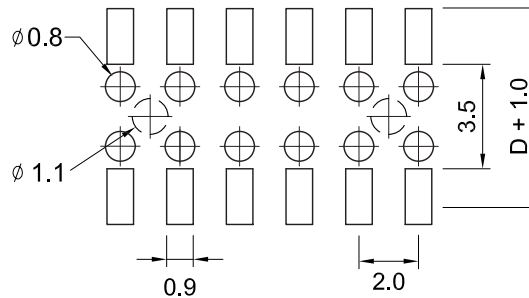

* Contact Plating Option	Full Gold Plating	Gold Plated On Contact Area Tin Plated on Solder Area	Full Tin Plating
	G : Gold Flash G10: Gold 10u" G15: Gold 15u" G30: Gold 30u"	S: Gold Flash S10: Gold 10u" S15: Gold 15u" S30: Gold 30u"	T: Tin 100u"

General Tolerance	
X. ± 0.50	X.° ± 5°
.X ± 0.20	.X° ± 2°
.XX ± 0.10	.XX° ± 1°
Units : mm	

Specifications

Current Rating: 2 Amps
 Insulator Resistance: 1000 Megohms min.
 Contact Resistance: 20 m ohms max.
 Dielectric Withstanding: AC 500V
 Operating Temperature: -40°C~+125°C
 Contact Material: Phosphor Bronze
 Insulator Material: Polyester, UL 94V-0, Nylon-6T
 Contact Plated: *see options below
 Standard: Full Gold Flash

Part Numbering System

FH2C-H3.0W4.0SD - TXXX - XX - XXXX

Series _____
Pin Type: _____
 5.4 = D: 5.40mm
 6.3 = D: 6.30mm
No. of Contact: _____
Post Option: _____
 Nil = w/o Alignment Pin
 A = with Alignment Pin
Contact Plating: _____
Cap Option: _____
 Nil = No Cap
 F = Film
 M = Metal
 P = Plastic
Packing Method: _____
 Nil = Tube
 T = Tape & Reel