

Pro Components

PRINTED CIRCUIT BOARD QUICK-FIT
MALE AND VERTICAL TYPE TERMINALS
6.35MM (0.25") TAB

TAB
6.35mm
(0.25")



MATERIAL:

Contact: Brass
Plated: Tin
Thickness: 0.762mm (0.03")
Mounting Holes: 1.32mm (0.052")

FEATURES:

Vertical Configuration Type Terminal
Offers Quick Connecting & Disconnecting of Female
Terminals
Pitch 5.08mm(0.200")

PC QUICK-FIT MALE TYPE TERMINALS 6.35mm(0.25") TAB

UNITS: Inches(mm)

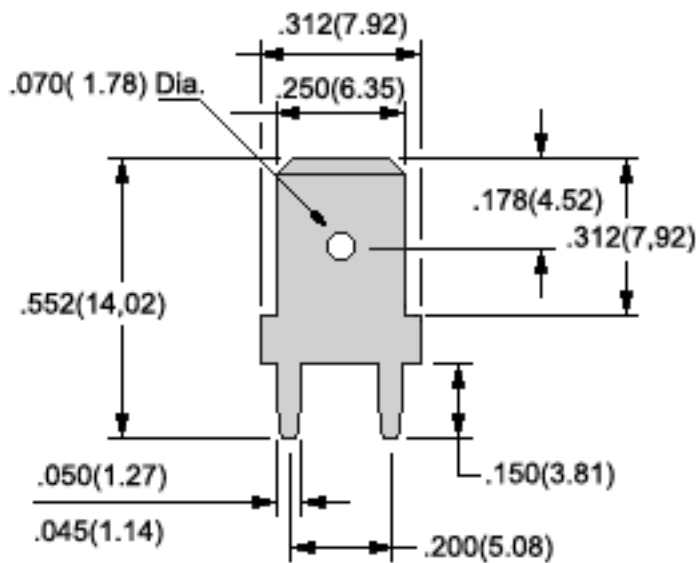

PART NUMBER: PCK-1287