

### MATERIAL & FINISHES

Insulator: Nylon-66 (Wafer, Housing)  
UL94V-2  
Color: Red Brick  
Contact: Copper Alloy  
Contact Finish: Gold or Tin over Nickel Plated

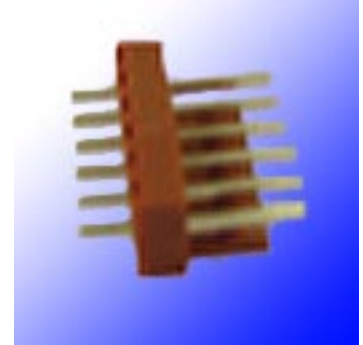

### ELECTRICAL CHARACTERISTICS

Rating Current: 7 Amp.  
Dielectric Withstanding Voltage: 1000V AC per Minute  
Insulation Resistance: 1000 MΩ Min.  
Contact Resistance: 20mΩ Max.  
Operating Temperature: -25°C to +85°C

### AVAILABLE MODELS

#### W25483 S

- S = Straight
- R = Right Angle
- L = Reverse Right Angle

### WAFER CONNECTOR

### W25483S/W25483R/W25483L

(PIN NO.-1)\*2.54±0.15

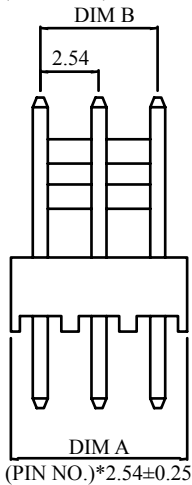

#### W25483R

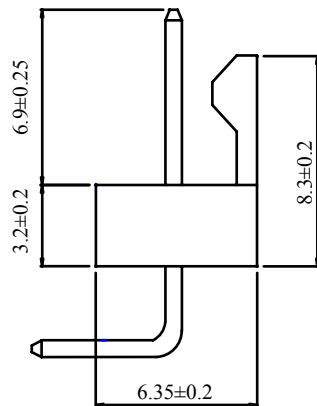

#### RIGHT ANGLE

#### W25483S

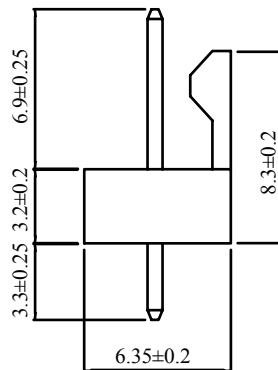

#### STRAIGHT

#### W25483L

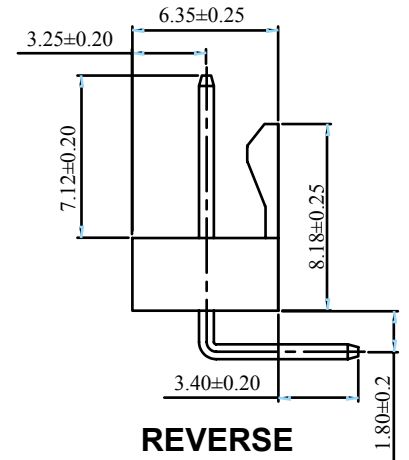

#### REVERSE RIGHT ANGLE

(PIN NO.-1)\*2.54±0.15

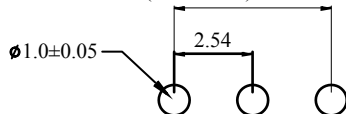

RECOMMENDED P.C.B. LAYOUT

